

De Vink Built Tug/Workboat

"PROTECTOR"



M/T Protector

1980/2007 – Vink (Dutch built), single screw, 13m x 4m x 1.5m tug, line running vessel, Engine DAF 375bhp bp-4ton, Class PLA Cat C & D, 11kva aux, tow hook, rope running guards, push knee.

Tug / Workboat

Builder

D Vink Netherlands 1980 – Re-designed 2007

Basic Functions

Towing, mooring, line running, barge handling, crew transfer, dredging support

Classification

PLA Cat C&D

Dimensions

Length 12.35 m x Beam 4.00 x Draft ±1.50 m

Tank Capacities

Fuel Oil

2.00 m³

Fresh Water

0.30 m³

Performances

Bollard Pull

4.0 tons

Speed (Max.)

9.0 knots

Propulsion System

Main Engines

1 x DAF DKT1160

Total Power

375bhp (De-rated) 325bhp

Gearboxes

1 x Twin Disc 3:1

Propulsion

1 x 4 Blade fixed pitch propeller

Diameter

1 x 1350 mm in semi tunnel

Auxiliary Equipment

Generator Set

1 x Beta 220/380v

Capacity

1 x 11 KVA

Deck Lay-out

Anchor

2 x Kedge type

Anchor Winch

Manual with warping head

Protection

Rope guards for line running

Features

Accommodation

Heated wheelhouse and cabin, galley, wheelhouse seating

Navigation & Communication Equipment

Koden radar

AIS A System

Garmin GPS with 10" Chart plotter

1 x Koden Echo Sounder

1 x Sailor 4822 (1 x DSC) VHF system

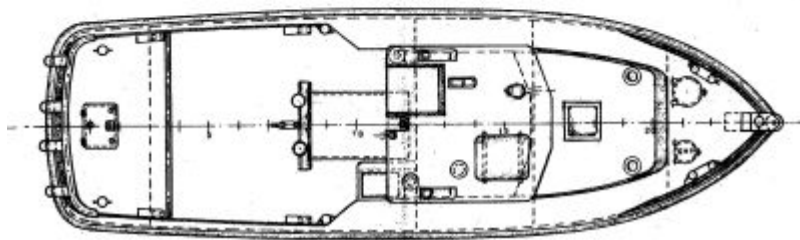
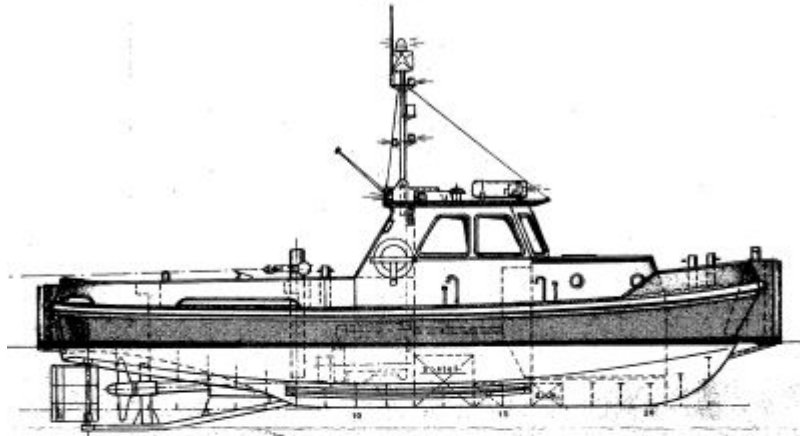

www.mstworkboats.co.uk

MST
MARINE SUPPORT THAMES

Marine Support Thames (M S T) Ltd

07973 820018

Email: craig@mstworkboats.co.uk